

# **POWDER PARTS, inc.**

## **Sure Coat Manual Gun**

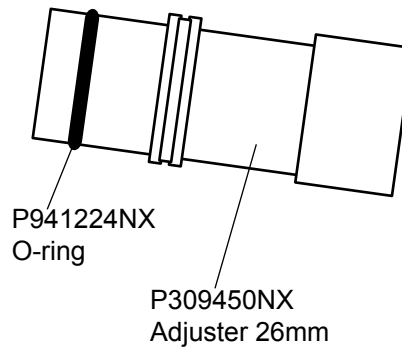
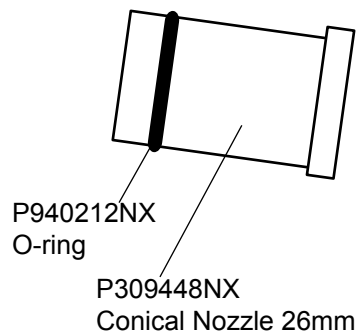
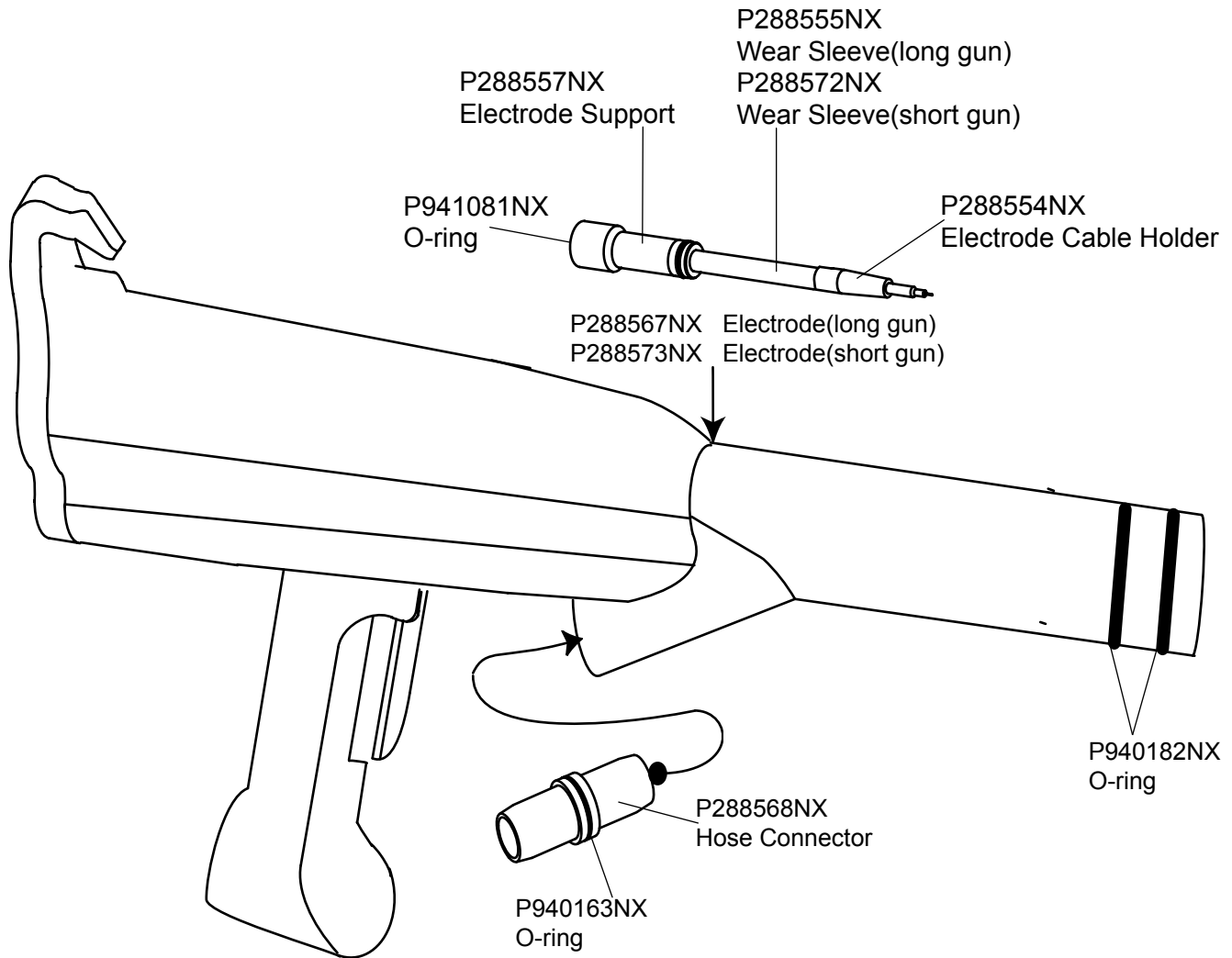

All parts are manufactured by or for Powder Parts, Inc., as "after market" replacement parts for powder coating equipment. The trademark names are owned by their respective companies and are used only for customer convenience.

## Sure Coat Nozzles

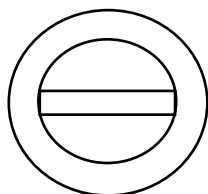
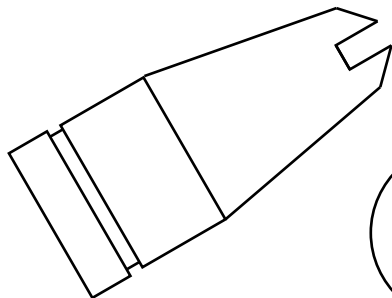

P302101NX	Flat spray nozzle 2.5mm (tivar)
P302108NX	Flat spray nozzle 2.5mm (glass-filled teflon)
P302102NX	Flat spray nozzle 3mm (tivar)
P302109NX	Flat spray nozzle 3mm (glass-filled teflon)
P302103NX	Flat spray nozzle 4mm
P302110NX	Flat spray nozzle 4mm (glass-filled teflon)
P302104NX	Flat spray nozzle 6mm (tivar)
P302111NX	Flat spray nozzle 6mm (glass-filled teflon)

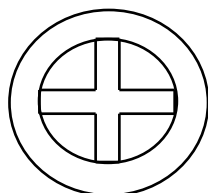

P302106NX	Cross cut nozzle 90 degree (tivar)
-----------	------------------------------------

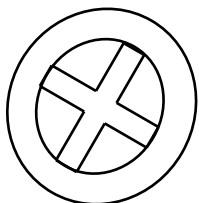

P302105NX	Cross cut nozzle 60 degree (tivar)
-----------	------------------------------------

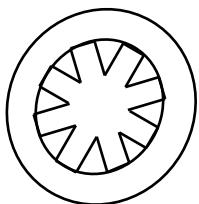

P302107NX	Castle nozzle
-----------	---------------



P135865NX	Deflector 14mm
P147880NX	Deflector 16mm
P173138NX	Deflector 19mm
P173141NX	Deflector 26mm
P249233NX	Deflector 38mm

## **Sure Coat Lance Extension**

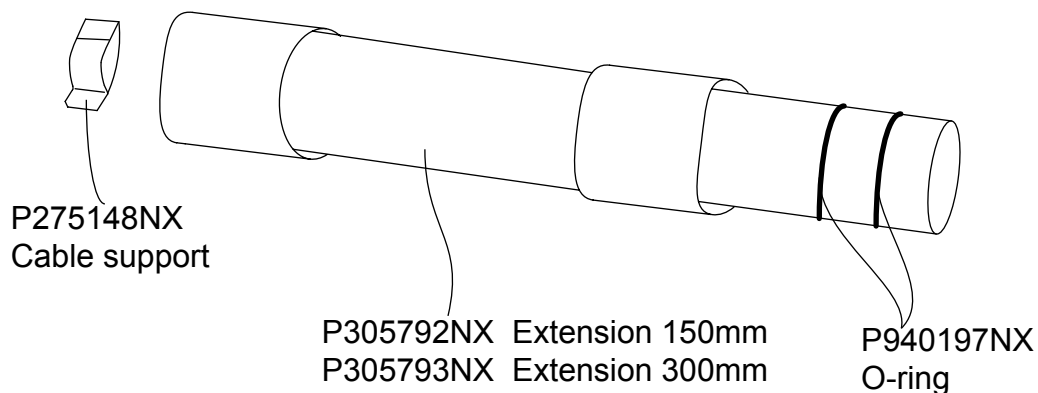
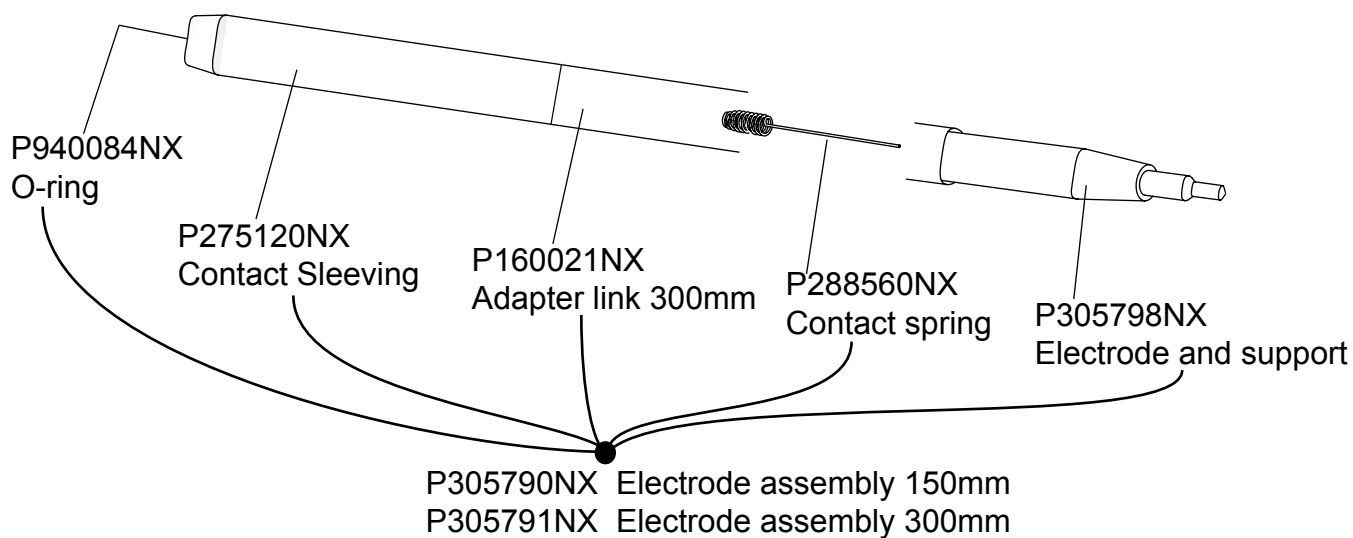

## **Corona Modular Pump/Purge Cleanable & Original Version**

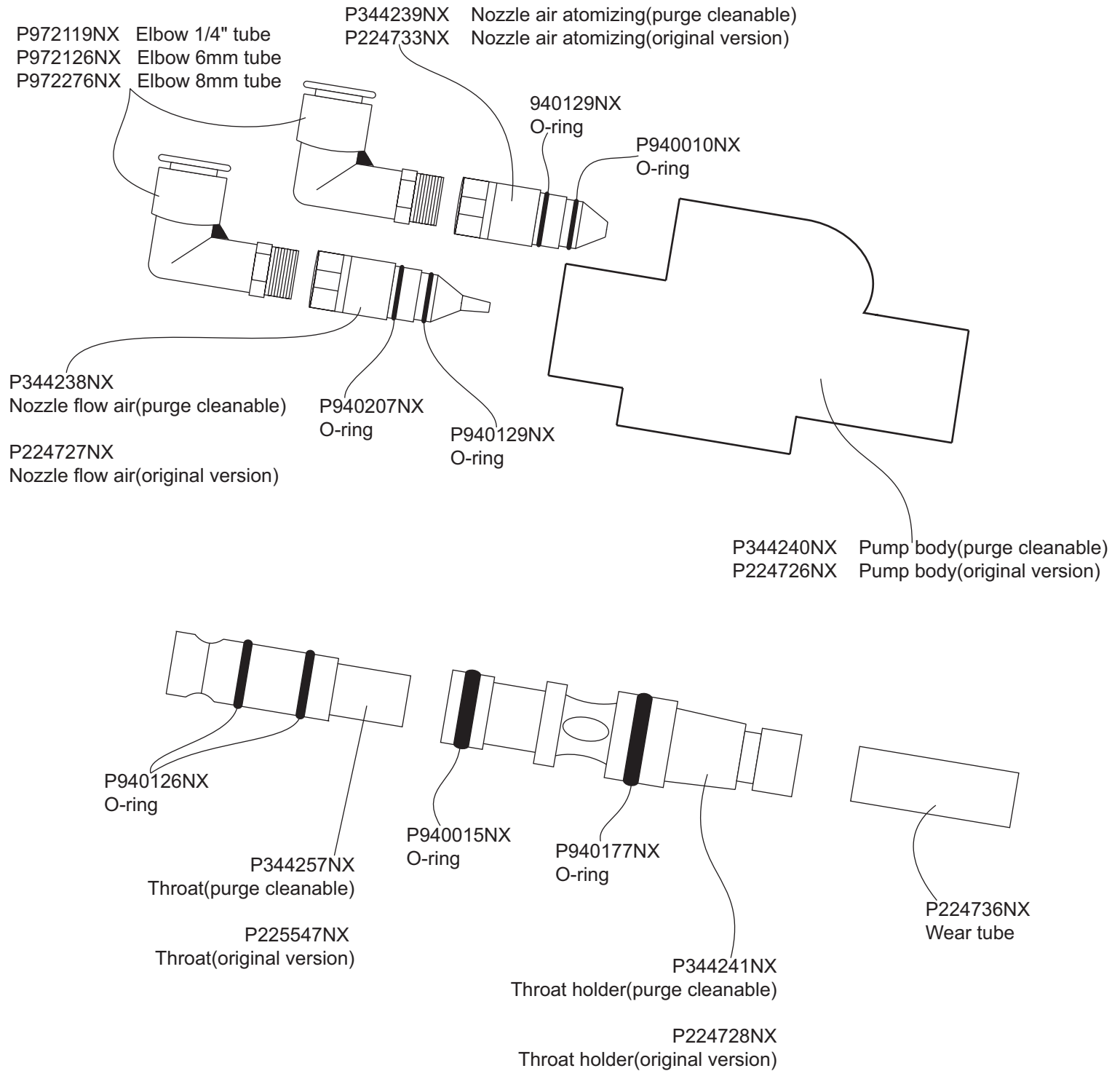

## **Pump adapter and pick-up tube, pull through the lid**

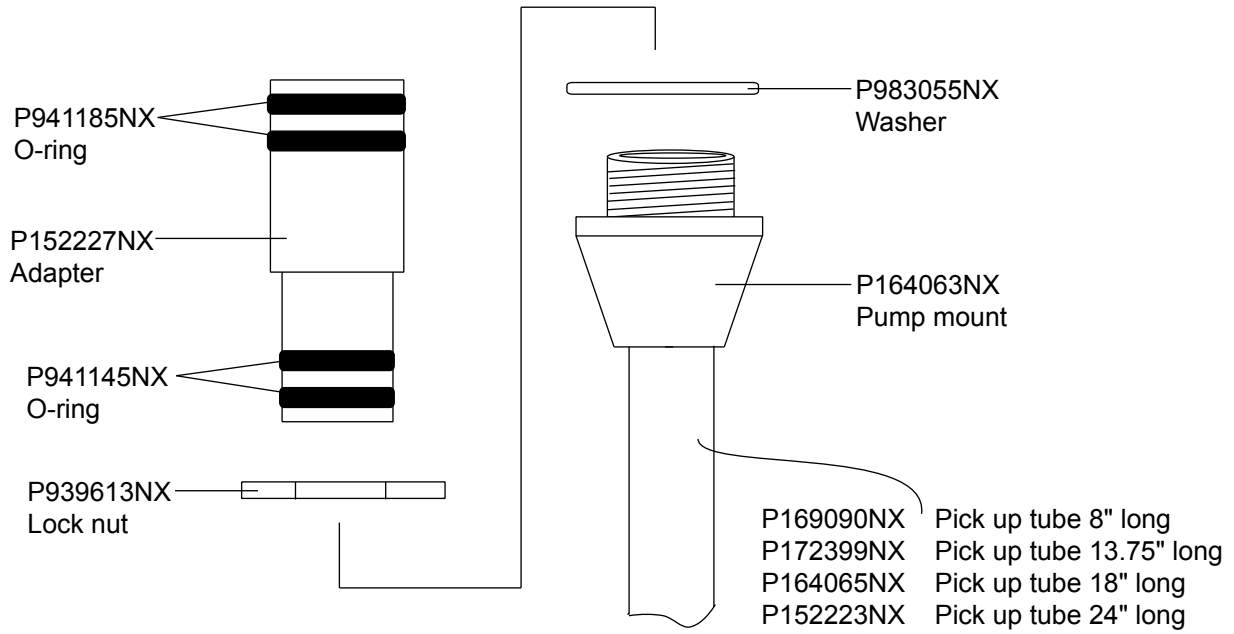

## **Pump adapter and pick-up tube, fixed mount**

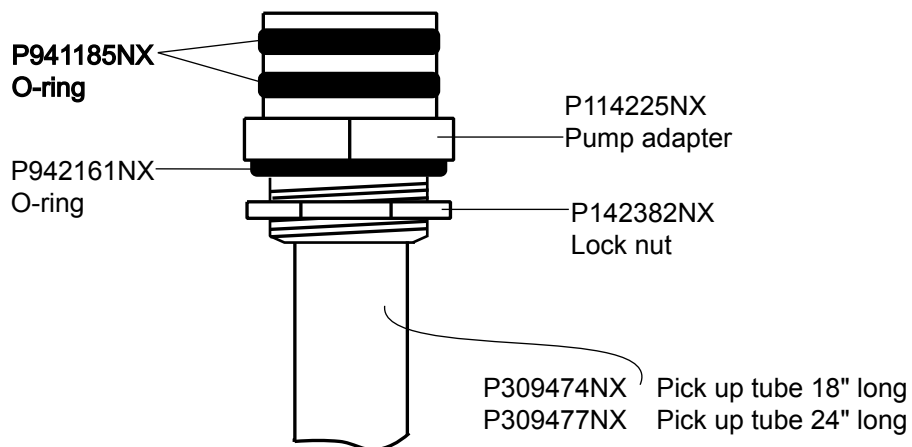



# Powder Transfer Pump, Old and New Style

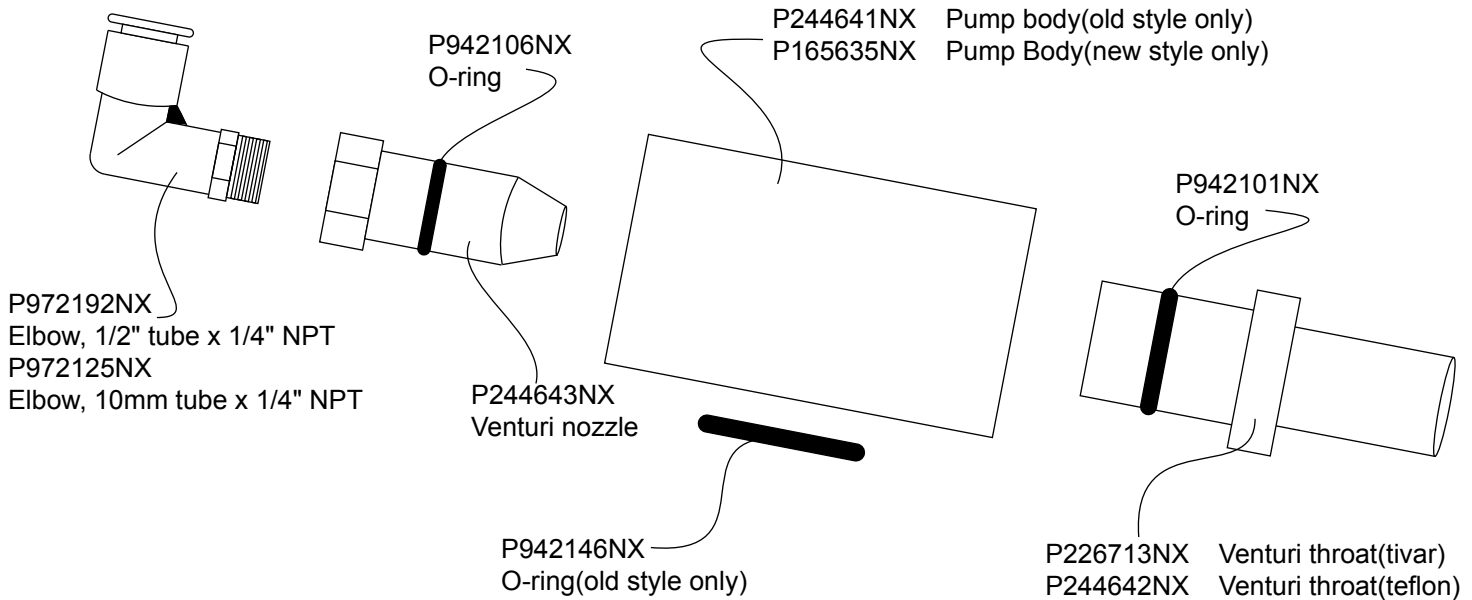

## Metric Powder Transfer Pump with Metal Throat Holder

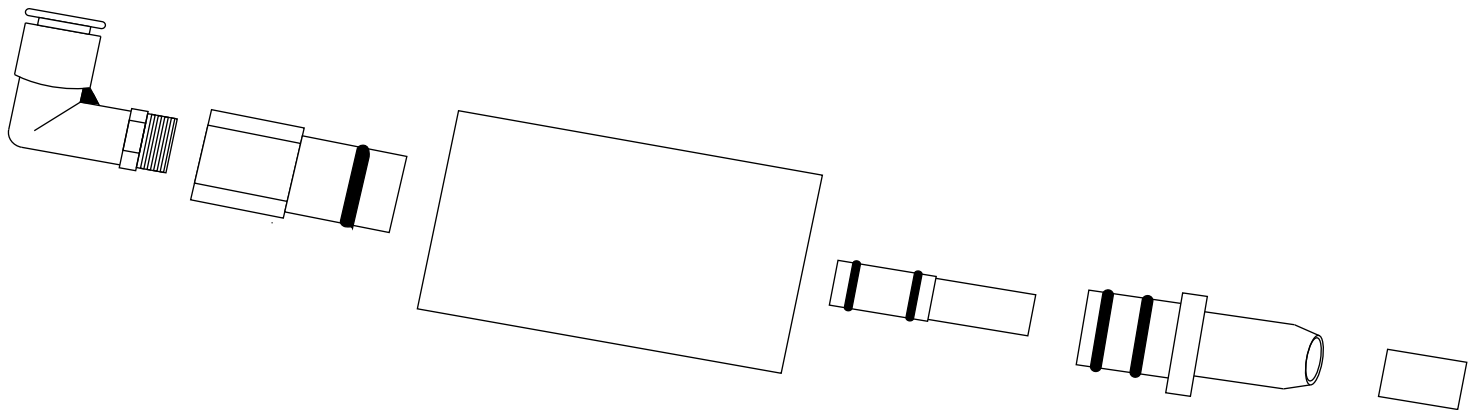

P972192NX  
 Elbow, 1/2" tube x 1/4" NPT  
 P972125NX  
 Elbow, 10mm tube x 1/4" NPT

All parts are manufactured by or for Powder Parts, Inc., as "after market" replacement parts for powder coating equipment. The trademark names are owned by their respective companies and are used only for customer convenience.

# **POWDER PARTS, inc.**

## **Versa Spray IPS Manual Gun**

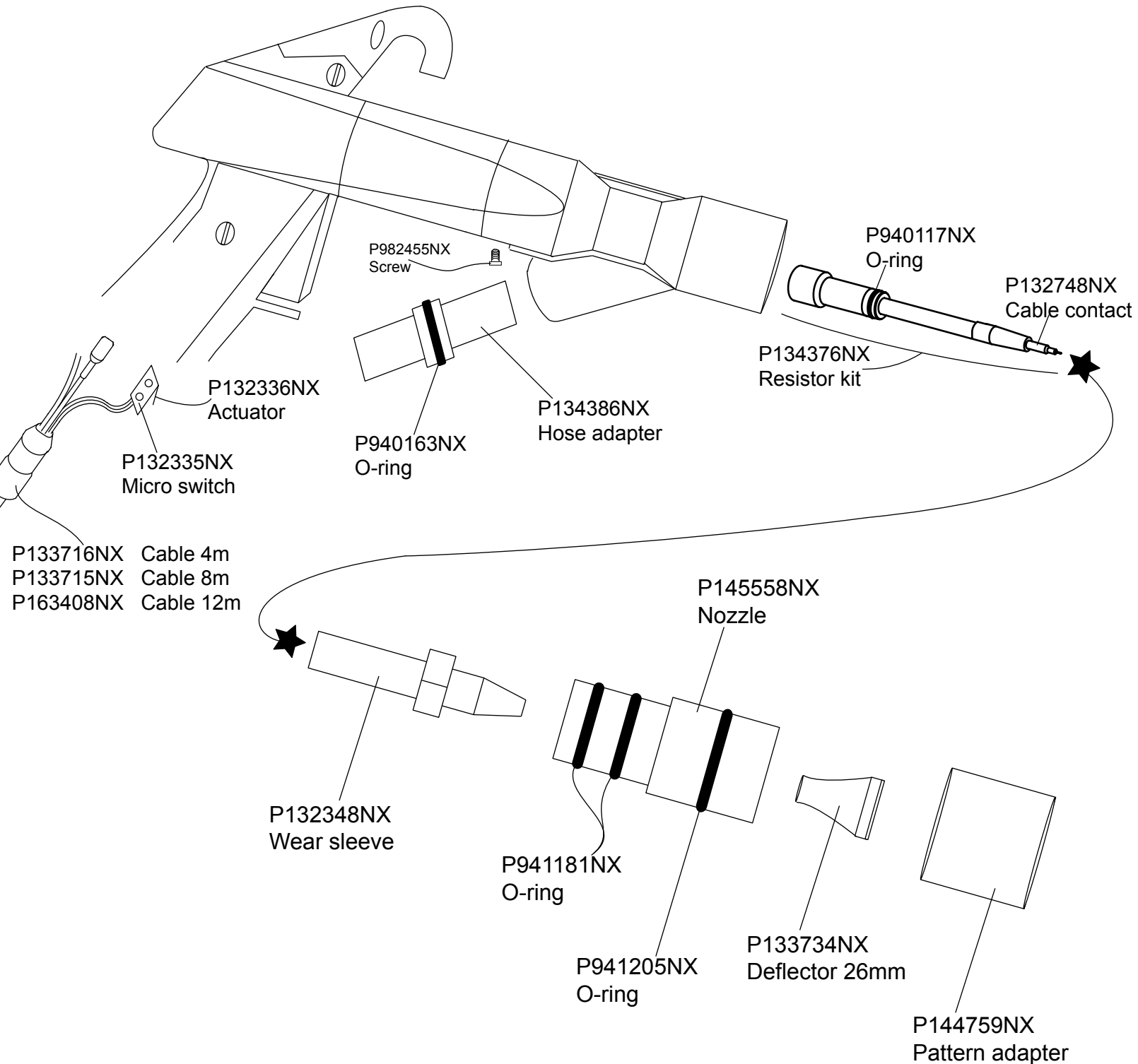

All parts are manufactured by or for Powder Parts, Inc., as "after market" replacement parts for powder coating equipment. The trademark names are owned by their respective companies and are used only for customer convenience.

# **POWDER PARTS, inc.**

## **Versa Spray Air Wash Extension Kit**

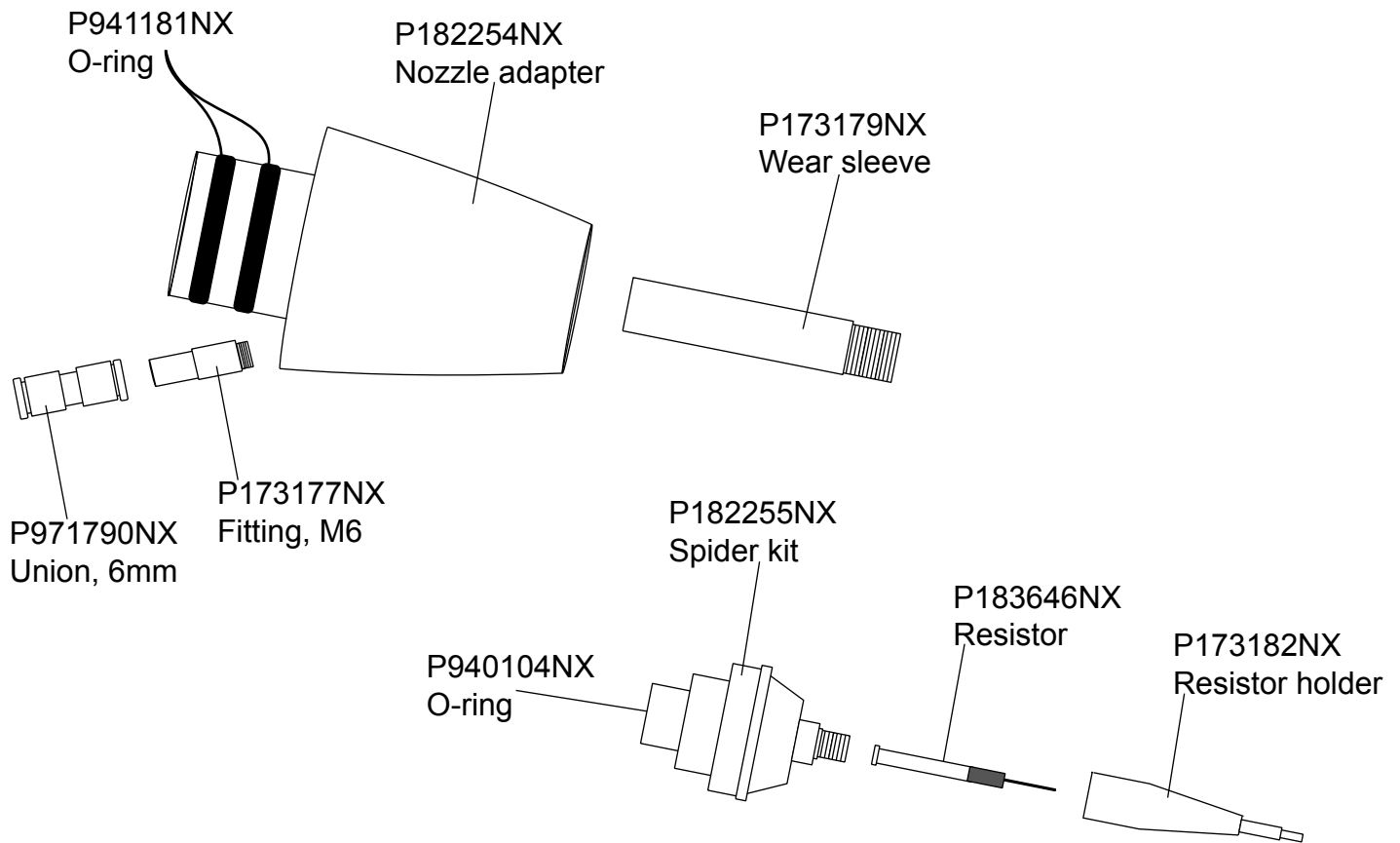

## **Versa Spray Conical Nozzles**

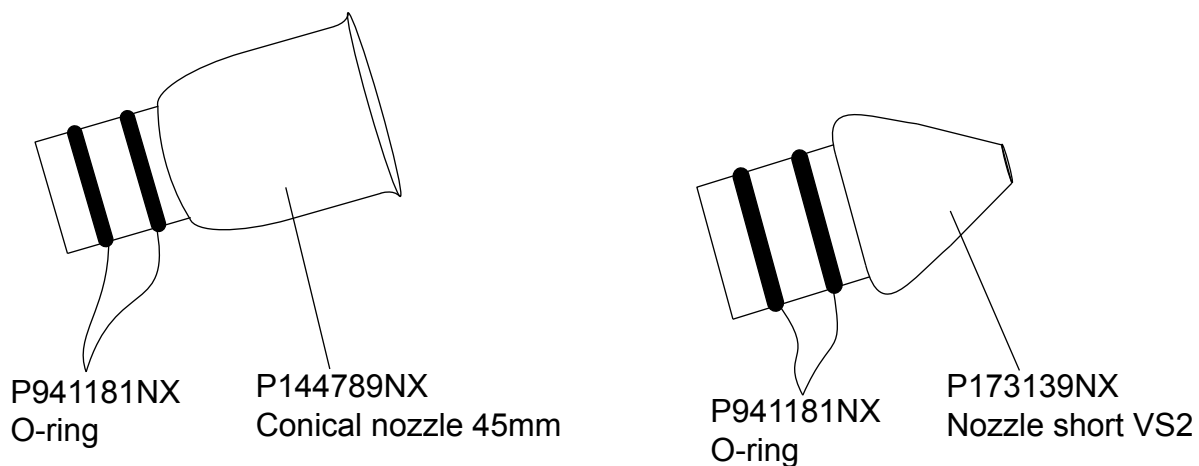

All parts are manufactured by or for Powder Parts, Inc., as "after market" replacement parts for powder coating equipment. The trademark names are owned by their respective companies and are used only for customer convenience.



# **POWDER PARTS, inc.**

## **Versa Spray Lightweight Lance Extension**

- P233469NX Extension complete 150mm
- P233468NX Extension complete 300mm
- P233455NX Extension complete 450mm

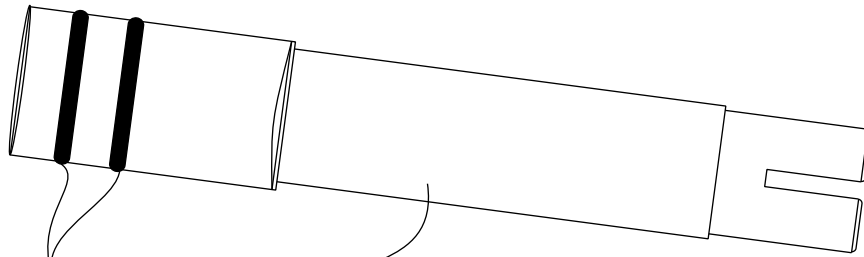

- P941181NX O-ring
- P233467NX Extension tube 150mm
- P233466NX Extension tube 300mm
- P233454NX Extension tube 450mm

- P160066NX Lance electrode 150mm
- P160068NX Lance electrode 300mm
- P233451NX Electrode assembly

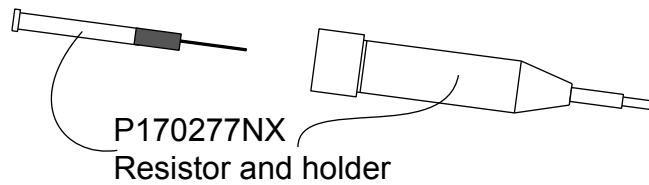

P170277NX  
Resistor and holder

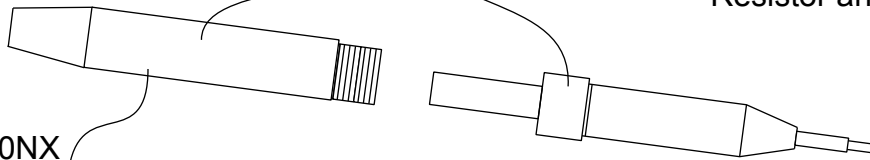

P160020NX  
Contact sleeving

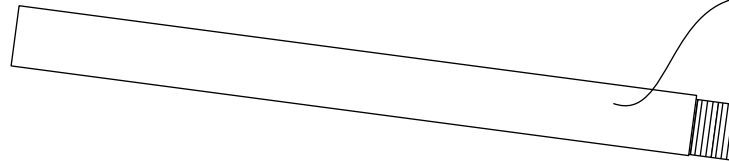

P160021NX  
Adapter link

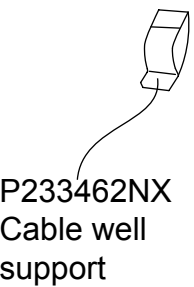

P233462NX  
Cable well support

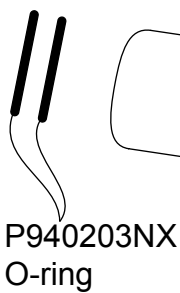

P940203NX  
O-ring

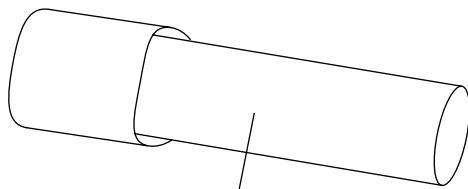

P233461NX  
Nozzle adapter

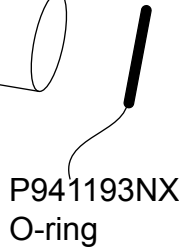

P941193NX  
O-ring

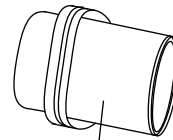

P233459NX  
Pattern adjuster

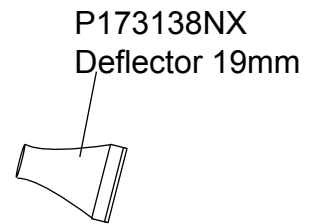

P173138NX  
Deflector 19mm

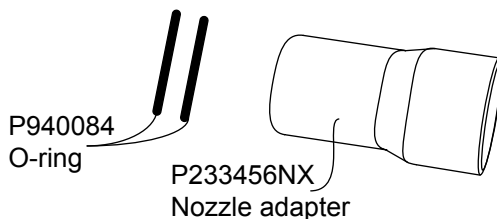

P940084 O-ring  
P233456NX Nozzle adapter

All parts are manufactured by or for Powder Parts, Inc., as "after market" replacement parts for powder coating equipment. The trademark names are owned by their respective companies and are used only for customer convenience.

# **POWDER PARTS, inc.**

## **Tribomatic II Charge Module Teflon**

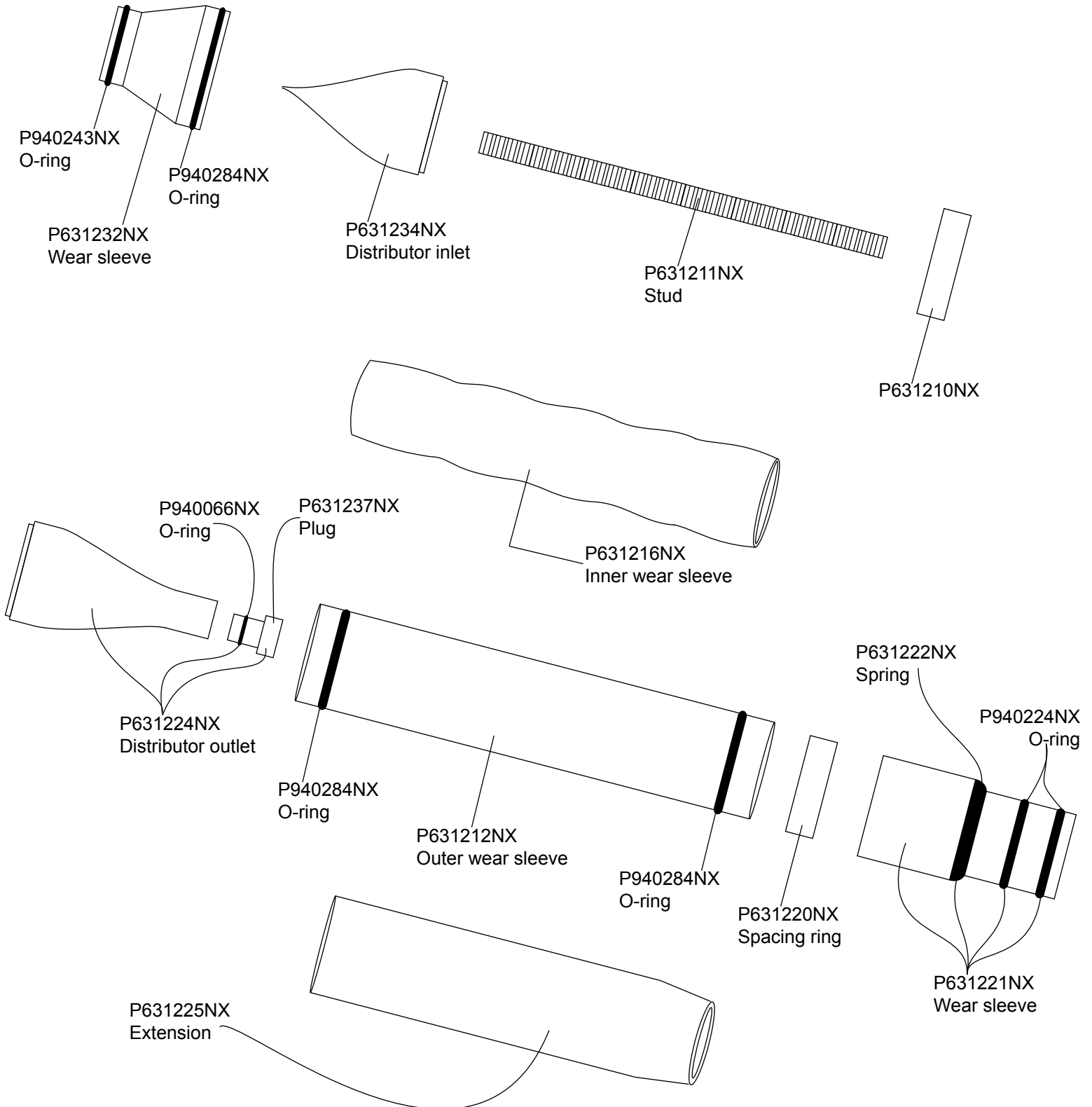

All parts are manufactured by or for Powder Parts, Inc., as "after market" replacement parts for powder coating equipment. The trademark names are owned by their respective companies and are used only for customer convenience.

## **Tribomatic II Service Kits**

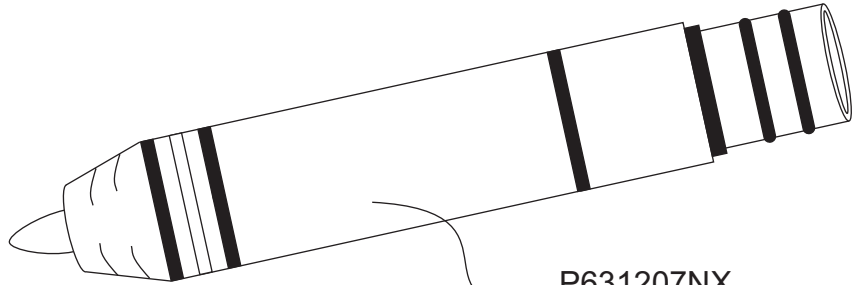

P631207NX  
Service kit charge module

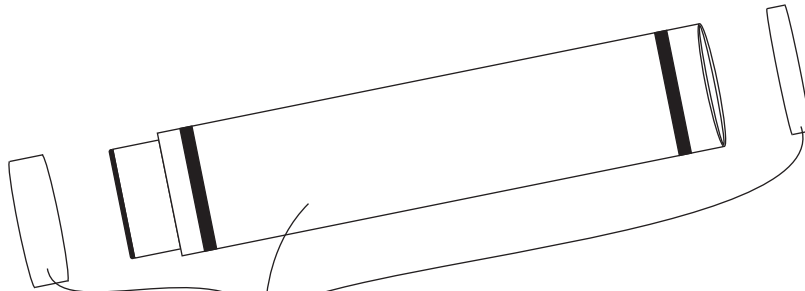

P631208NX  
Service kit inner/outer wear sleeves

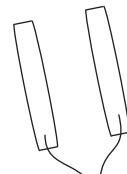

P631209NX  
Service kit rings

## **Tribomatic II Diffuser**

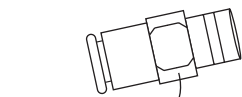

P972080NX  
Connector

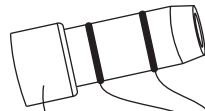

P635007NX  
Nozzle diffuser

P940117NX  
O-ring

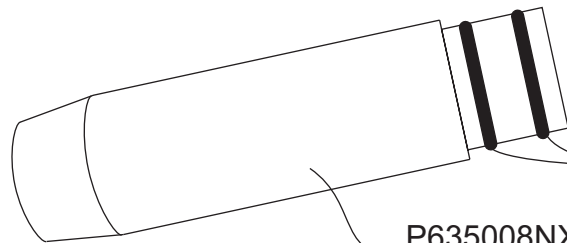

P635008NX  
Housing diffuser

P940224NX  
O-ring



P631275NX  
Connector diffuser

P939247NX  
Hose clamp

# POWDER PARTS, inc.

## Model 2M Manual Gun

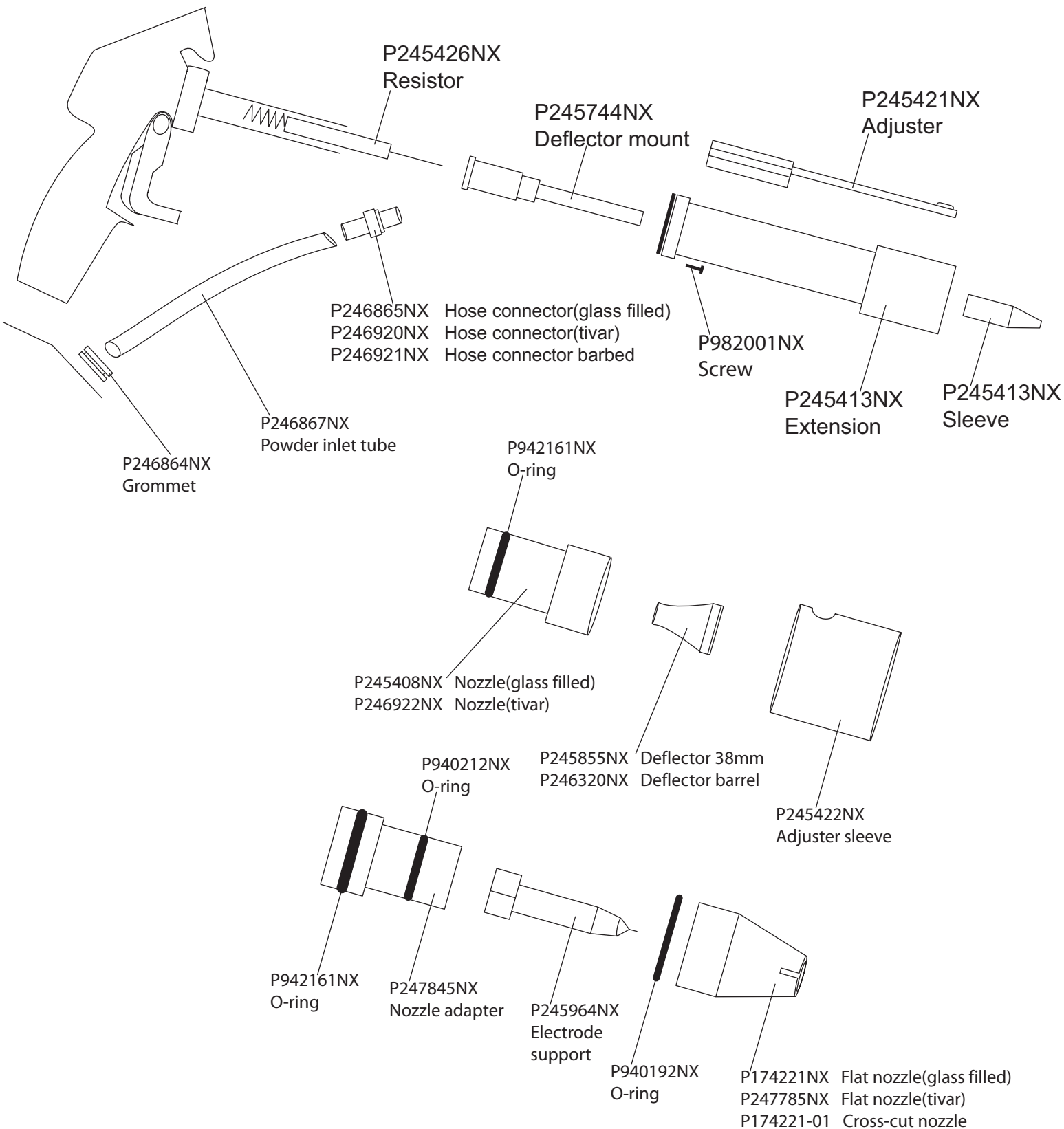

All parts are manufactured by or for Powder Parts, Inc., as "after market" replacement parts for powder coating equipment. The trademark names are owned by their respective companies and are used only for customer convenience.

# **POWDER PARTS, inc.**

## **100Plus Series II, 2A and 2M Guns Lance Extension**

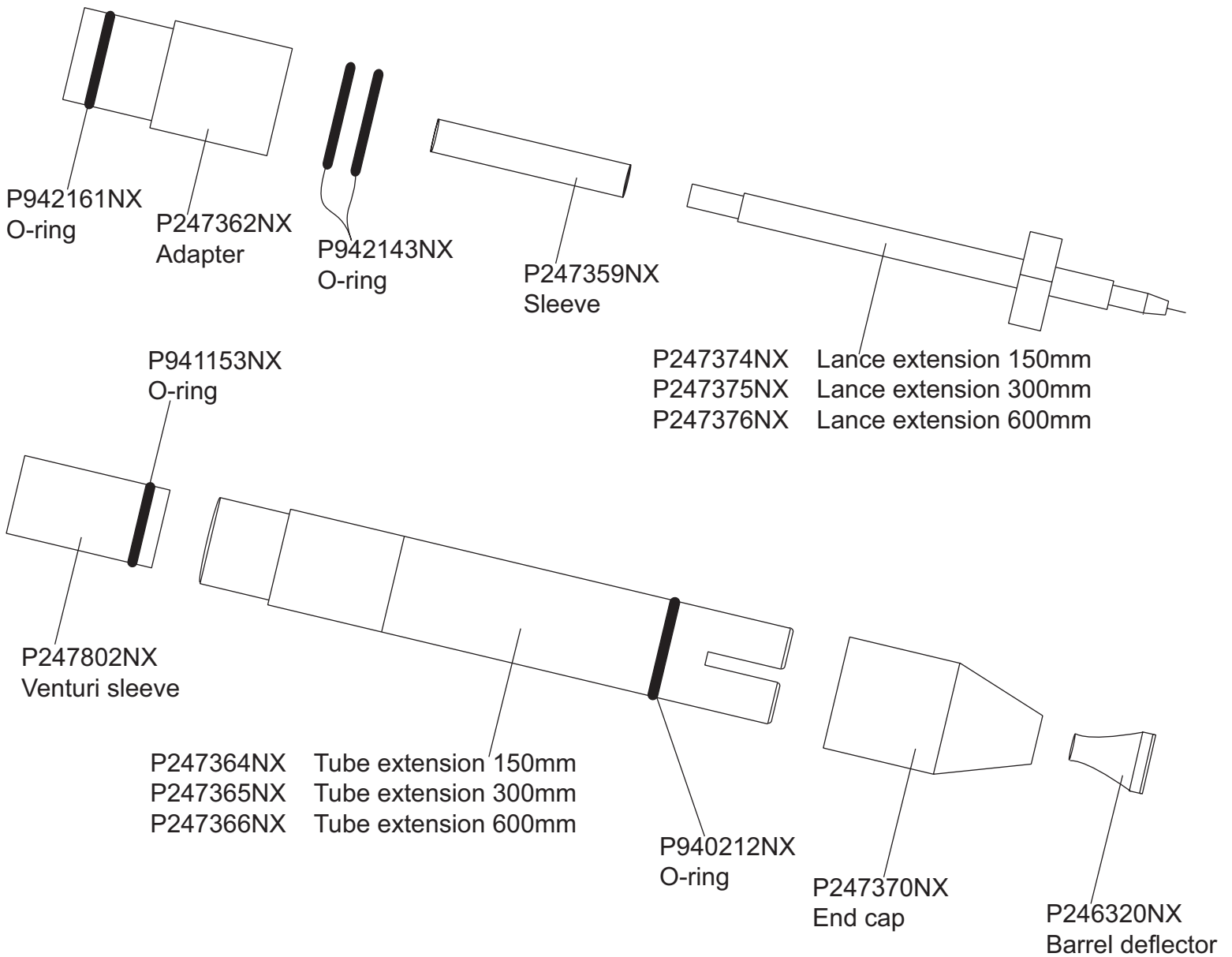

All parts are manufactured by or for Powder Parts, Inc., as "after market" replacement parts for powder coating equipment. The trademark names are owned by their respective companies and are used only for customer convenience.

## **100 Plus Powder Pump**

P249500NX Powder pump complete, standard flow  
 P142062NX Powder pump complete, low flow

P972119NX Elbow, 1/4 tube x 1/8 NPT  
 P972126NX Elbow, 6mm tube x 1/8 unitthread  
 P972276NX Elbow, 8mm tube x 1/8 unitthread

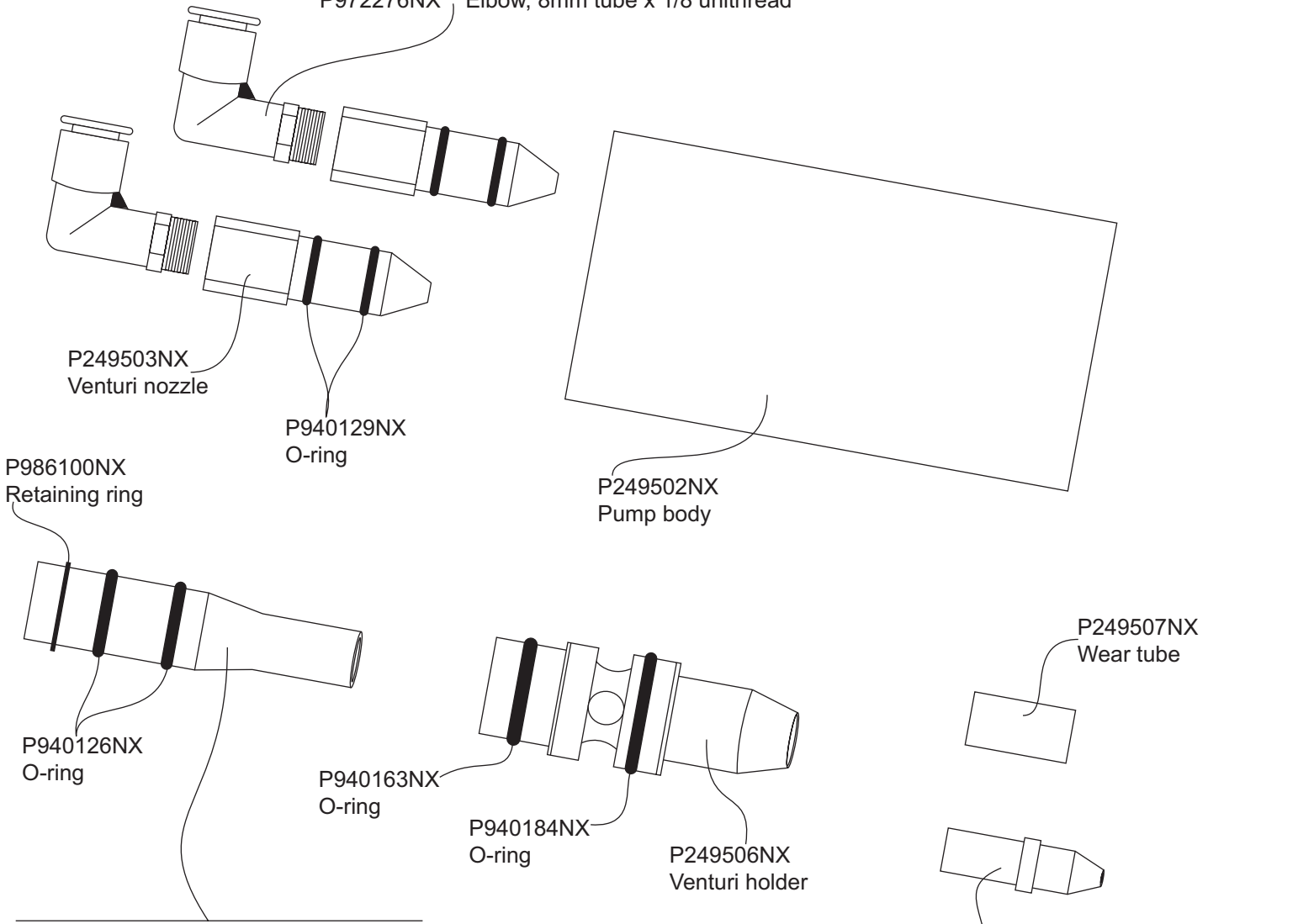

P249503NX  
Venturi nozzle

P940129NX  
O-ring

P986100NX  
Retaining ring

P249502NX  
Pump body

P940126NX  
O-ring

P940163NX  
O-ring

P940184NX  
O-ring

P249506NX  
Venturi holder

P249507NX  
Wear tube

P139943NX  
Hose connector(low flow pump only)

P114221NX Venturi, standard flow(tivar)  
 P249504NX Venturi, standard flow(teflon)  
 P174215NX Venturi, standard flow(glass-filled)  
 P114223NX Venturi, standard flow(stainless-steel)  
 P114219NX Venturi, low flow(tivar)  
 P109101NX Venturi, low flow(teflon)  
 P174213NX Venturi, low flow(glass-filled)